

LUBRICATE ALL SEALS WITH CLEAN HYDRAULIC OIL PRIOR TO ASSEMBLY. DO NOT USE SILICONE BASED LUBRICANTS.

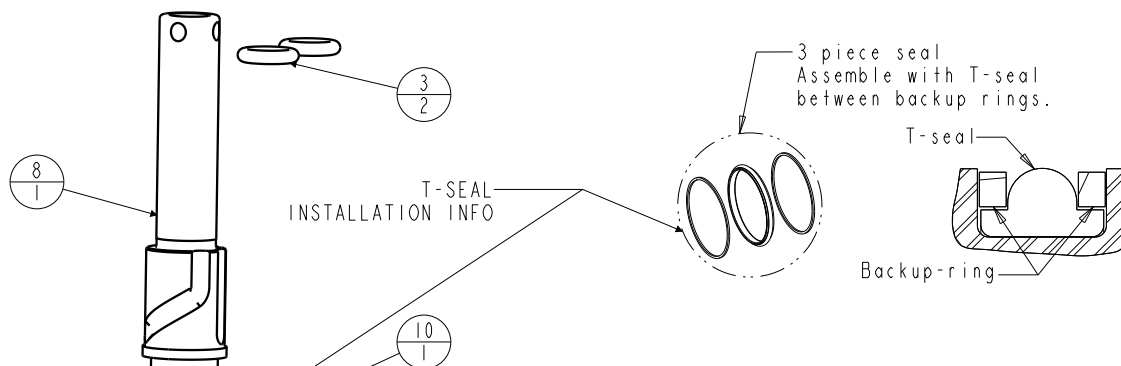
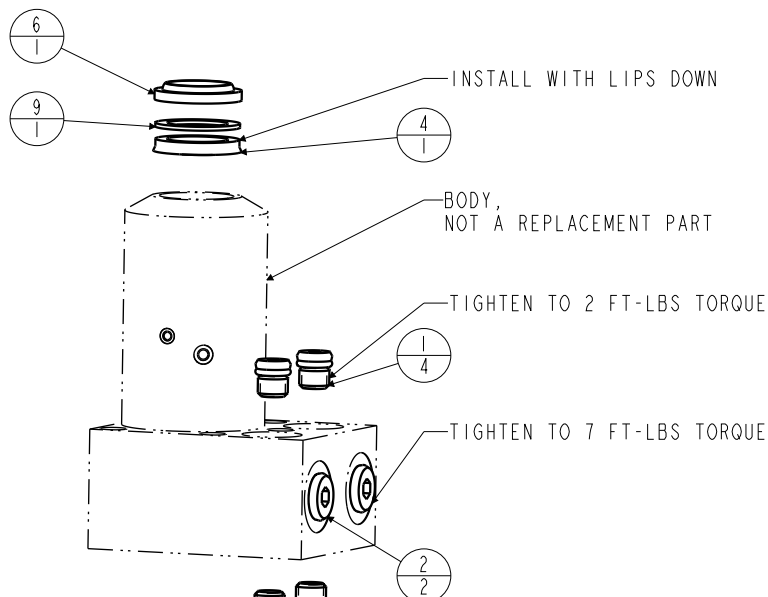

TIGHTEN TO 30 FT-LBS TORQUE.

N/A	N/A	6V252203	KIT, SEAL, FKM	N/A	NOTED
N/A	N/A	60252203	KIT, SEAL, STANDARD	NOTED	N/A
10	1	39H10018	SEAL, T, (11/16 X 5/32 X 7/8)	X	39V10018
9	1	39F54001	BU RING, (-208 CUSTOM)	X	39F54001
8	1	81510901	PLUNGER, SC, 1100#		
7	1	81400029	RETAINER, SC, HS, 1100		
6	1	39053001	WIPER, SNAP-IN, (5/8)	X	39051031
5	1	39051031	O-RING, (-912)	X	39053001
4	1	39010020	SEAL, BEVEL W/HEEL INSERT, 5/8 x 1/8 x 7/8	X	39V10020
3	2	39000050	O-RING, (-204)	X	39051022
2	2	30601144	PLUG, SOCH, SAE 4		
1	4	30601122	PLUG, SOCH, SAE 2		
No.	QTY	PART No.	DESCRIPTION	STANDARD SEAL KIT	FKM SEAL KIT

PARTS LIST



VEKTEK, INC.
1334 E. SIXTH AVE. P.O. BOX 625
EMPORIA, KS. 66801 U.S.A.

ASSEMBLIES AFFECTED
25220902
25220902F

PARTS LIST, ASSY, CYL, PP, BF, 3000/1400

SIZE A
PL2508

REV A

A	4430	RELEASE	NPETERS	5/13/21
REV	IN ACCORDANCE WITH ECN	EFFECTIVE DATE	REVISED BY	DATE
DRW BY:	NPETERS	DRAWING STATUS: Released		
DATE:	5/13/21	PRODUCTION APPROVED FOR RELEASED STATUS ONLY		

FORM FEG035_PL_ASIZE, REV. B

SHEET 1 OF 1